



Kingsbridge Drive

Offers In Excess Of £1,100,000

OVER 2000 SQ FT - LIDBURY SQUARE DEVELOPMENT - 5 BED 3 BATHROOM DETACHED HOUSE.

This wonderful property is arranged over 3 floors and situated on a tree lined road. The ground floor comprises of a bright and spacious reception room, an additional reception room and a large open plan kitchen-diner with a separate utility room and W/C. The first floor boasts 4 bedrooms and 2 bathrooms (1 en-suite). On the top floor there is a master bedroom with en-suite.

Further benefits include off-street parking, walking distance to Waitrose, Virgin Active and Mill Hill East Station. Chain Free. Sole Agent.

Viewing

Please contact our Mill Hill Office on 020 8959 0011 if you wish to arrange a viewing appointment for this property or require further information.



5



3



2



Floor Plan

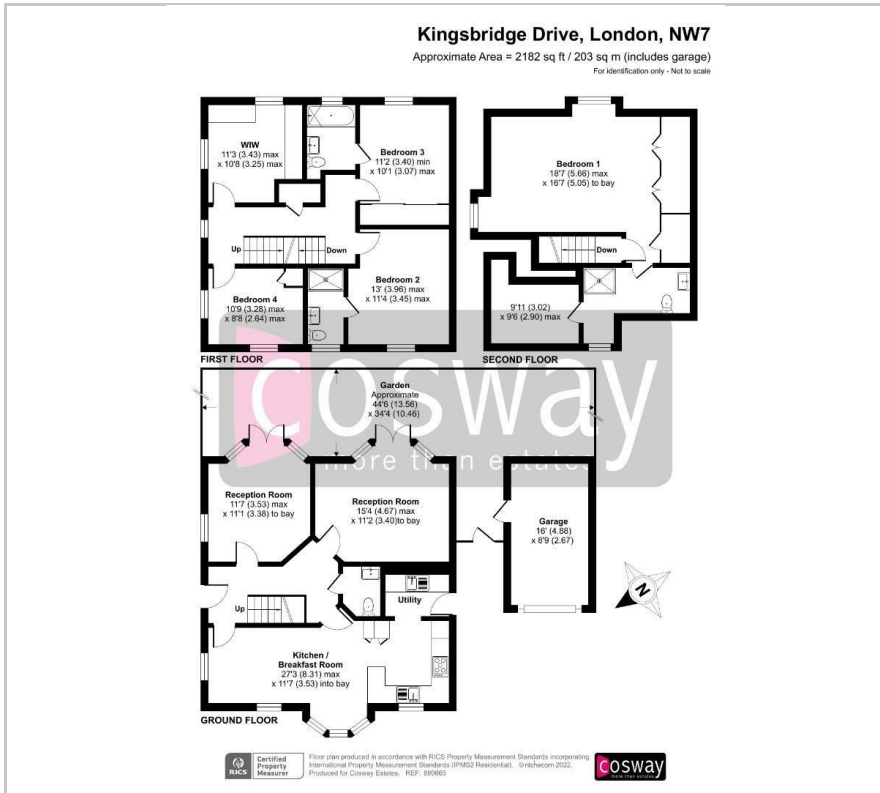

Area Map

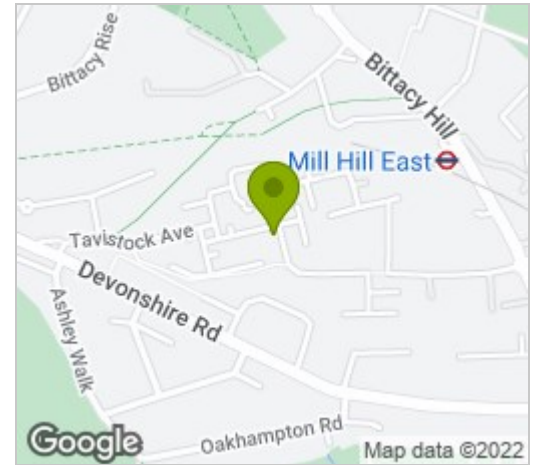

Energy Efficiency Graph

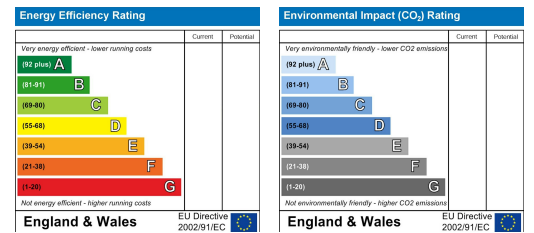

These particulars, whilst believed to be accurate are set out as a general outline only for guidance and do not constitute any part of an offer or contract. Intending purchasers should not rely on them as statements of representation of fact, but must satisfy themselves by inspection or otherwise as to their accuracy. No person in this firm's employment has the authority to make or give any representation or warranty in respect of the property.